

Electrical Characteristics :

- Insulation Resistance : 100MΩMin.
- Contact Resistance : 500mΩ Max.
- Withstand Voltage : 100 VAC 1 minute.
- Current Rating : 1.5A

Material:

- Housing : Thermoplastic UL94V-0
- Contact : Selective Gold Plating
- Terminal: 0.25mm Thickness Phosphor Bronze Plated With Gold And Tin In Solder Area.
- Shield : SUS

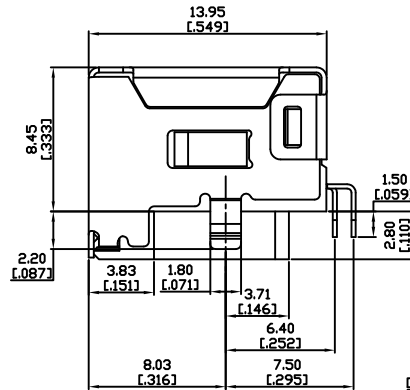
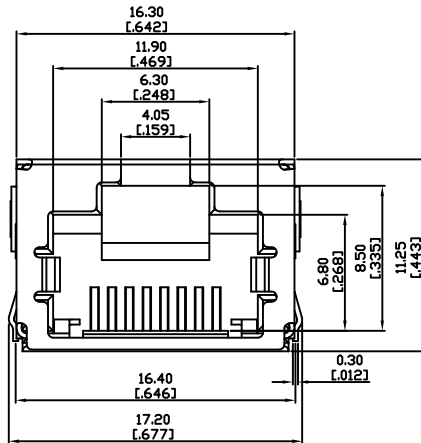

PART NO : 8 1 8 8 K4 - B * 1 0

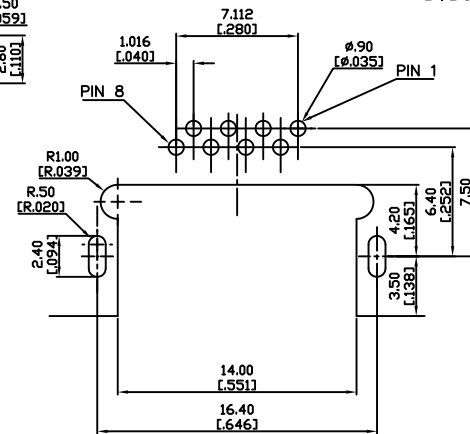
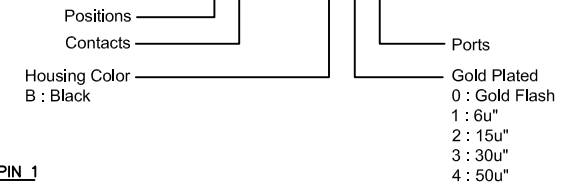

RECOMMENDED PCB LAYOUT

DEFAULT TOLERANCE : ±0.05
PCB THICKNESS: 1.20±0.05mm

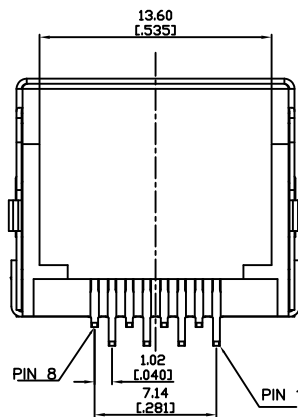

PW 博崴電子股份有限公司
POWERWAY ELECTRONICS CO.,LTD.

ZONE	REV.	DESCRIPTION	DATE	APPD.	FILE NO : 81 (SERIES)	TITLE	RJ45, 8P8C, Shielded, Offset Type, Thru Hole, RJ11 Mateproof Function		UNIT	mm inch
(A)					TOLERANCE(公差): 0.000 mm ± 0.075 mm 0.00 mm ± 0.15 mm 0.0 mm ± 0.25 mm	圖名			單位	
(B)						料號	8188K4-B*10		SCALE	1:1
(C)						版本	A.0	DATE	2010-05-14	
(D)						日期				
(E)						審核	Aaron		DRAWN BY	Eric